

Rotary Tillers

RTR2570 Model	
Recommended Tractor PTO HP	25-55 Horsepower (55 hp maximum)
Weight	868#
Tilling Width	70"
Overall Width	76"
3-Point Hitch Type	Category 1 with Adjustable lower Hitch Clevises Fits Land Pride Quick-Hitch
Offset Capabilities	Yes (Cannot offset with Quick-Hitch)
Number of Flanges	9
Number of Tines per Flange	6 "C" blades
Tine Construction	High Carbon heat treated "C" shaped blades
Skid Shoes	Adjustable
Storage Stands	Adjustable
Rear Deflector	Spring Loaded, adjustable, profile stamped rear deflector
Front Protector	Plate with reinforced rubber insert
Driveline	ASAE Category III Heavy Duty Friction Clutch-Standard
Gearbox	45 HP Input at 540 rpm 1.92:1 Ratio Cast Iron Housing, Straight Bevel Gears
Gearbox Oil Capacity and Type	3.17 Pints of Gear Lube 80-90W EP
Drive Chain	#100 Roller chain - Fully enclosed in oil bath with drain plug, fill plug & skid protection
Drive Chain Lubrication	Shell Alvania EP 00
Sprockets	Splined Bores
Rotor Swing Diameter	17"
Rotor Shaft Speed	220 rpm at 540 rpm PTO
Recommended Tractor PTO HP	25-55 Horsepower (55 hp maximum)

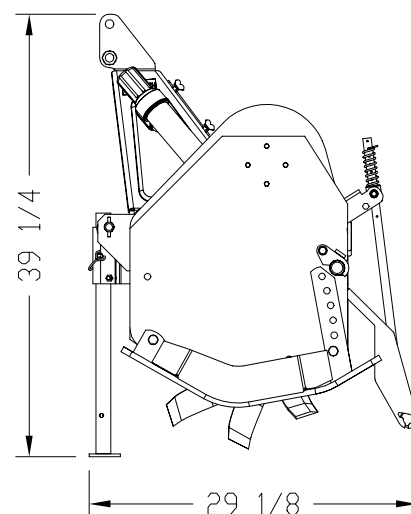
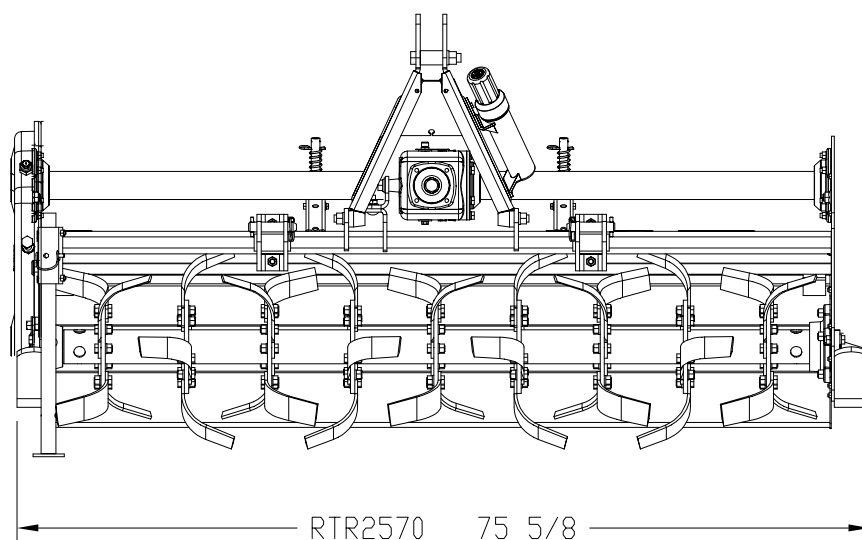

17679

Designs, specifications, features and information are subject to change without notice.